

REF 12937

KIATO Safety Scalpels help to minimize the risk of surgical blade injuries that occur before use, during passing, between steps of the procedure, after use and during disposal. The Safety Scalpel is designed to be used single handedly.

Patent No: 7,097,087

1. Ship/Pass position:



The retractable sheath securely covers the blade fully. The latch must be released to retract the sheath backwards to the Use Position. The sheath does not retract backwards without activation.

2. Use position:



The Stitch cutter is exposed and ready for use. Audible click confirms sheath is fully retracted.



Packed in easy peel rigid blister pouches. 10 scalpels per unit box, 10 boxes per case, 10 case per Master Shipper.

Directions for use

To Use:

Press Release button marked On to depress latch on handle and retract sheath fully until it clicks. The blade is now exposed and the sheath is locked in the "USE" position

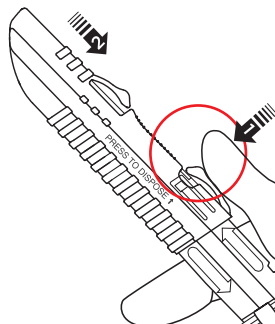

To Pass:

Press Release button marked Off and slide sheath forward to initial position until it locks in the pass position.

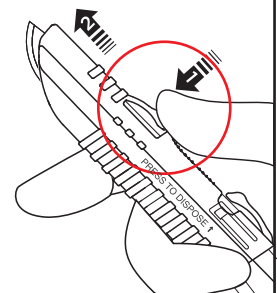

To Dispose

Step 1

Slide Sheath to "pass position". Push dispose button inwards into handle until it clicks & locks.

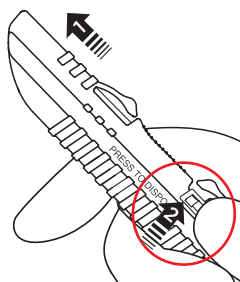

Step 2

Dispose in an approved sharps container.

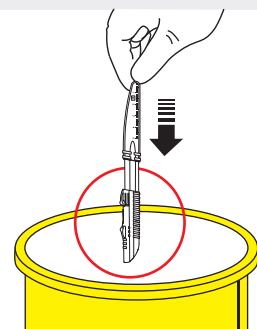

STERILE DISPOSABLE SAFETY STITCH CUTTER is your best choice for removal of skin sutures.

- Premium Swedish Stainless Steel.
- Colour coded handle with Size No clearly printed
- Durable sharpness.
- Clearly printed instructions.
- Cap Safely locked in ship & pass position.
- Permanent Dispose button

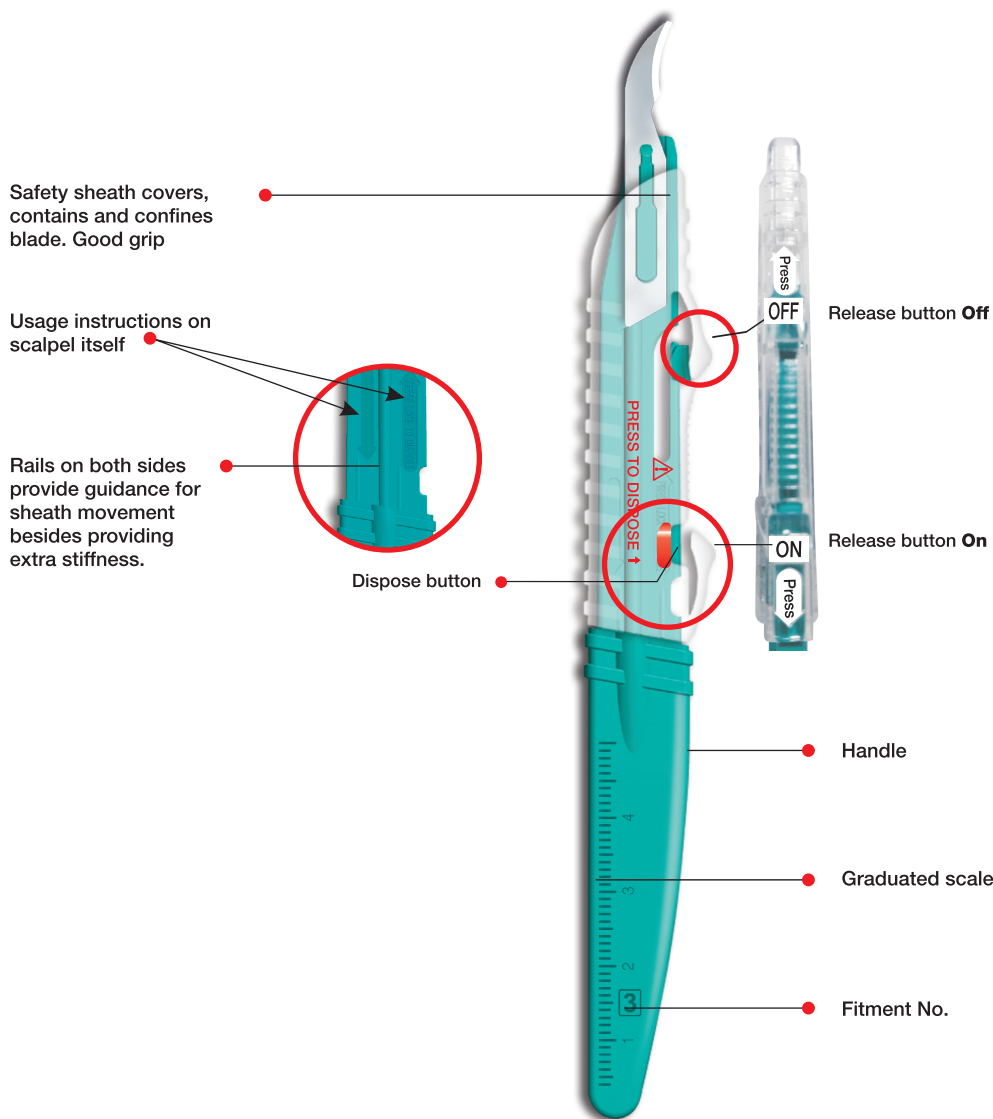

MDSS GmbH
Schiffgraben 41
30175 Hannover
Germany



Aditya Dispomed Products Pvt. Ltd.
Plot No. 19 Sector 6 IMT Manesar
Gurgaon Haryana I22050 India
Tel. +91 124 47 64 900
Fax +91 124 47 64 911
info@adityadisposed.com
www.adityadisposed.com

The smart choice for sharp blades

A subsidiary of Kehr Surgical Pvt. Ltd.