

KIATO Safety Scalpels help to minimize the risk of surgical blade injuries that occur before use, during passing, between steps of the procedure, after use and during disposal. The Safety Scalpel is designed to be used single handedly.

### 1. Ship/Pass position:

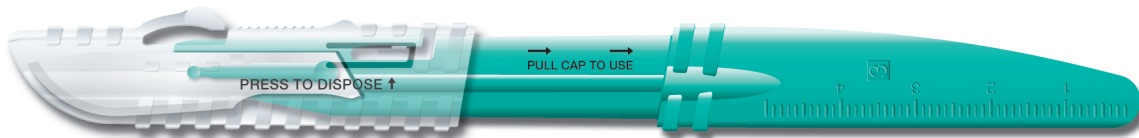

Sheath covers the blade to safely pass. Audible click confirms sheath is extended and covers blade. To permanently lock refer "To Dispose".

### 2. Use position:

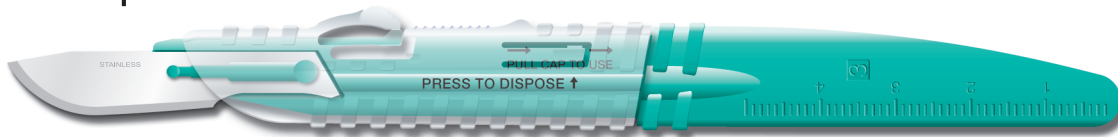

The Surgical Blade is exposed and ready for use. Audible click confirms sheath is fully retracted.

## Directions for use

### To Use:

Grip Cap behind release button with thumb & forefinger & retract sheath fully till it clicks. The blade is now exposed and the sheath is locked in the "USE" Position.

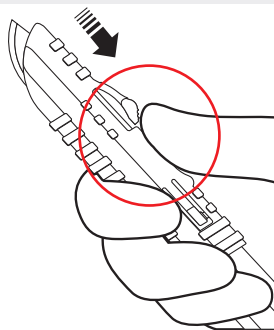

### To Pass:

Gently press release button downwards with thumb & slide sheath forward to initial position till it locks in the pass position.

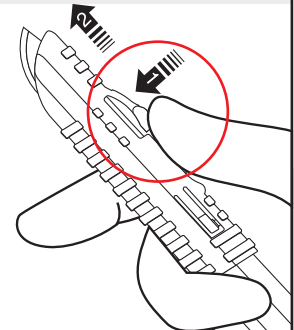

### To Dispose

#### Step 1

#### Step 2

Slide Sheath to "pass position". Push dispose button inwards into handle till it clicks & locks.

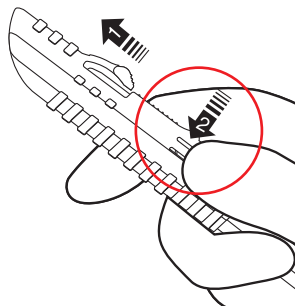

Dispose in an approved sharps container.

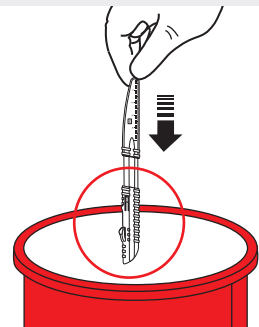

MDSS GmbH  
Schiffgraben 41  
30175 Hannover  
Germany



aditya  
DISPOMED

A subsidiary of Kehr Surgical Pvt. Ltd.

Aditya Disposed Products Pvt. Ltd.  
Plot No. 19 Sector 6 IMT Manesar  
Gurgaon Haryana 122050 India  
Tel. +91 124 47 64 900  
Fax +91 124 47 64 911  
info@adityadisposed.com  
www.adityadisposed.com

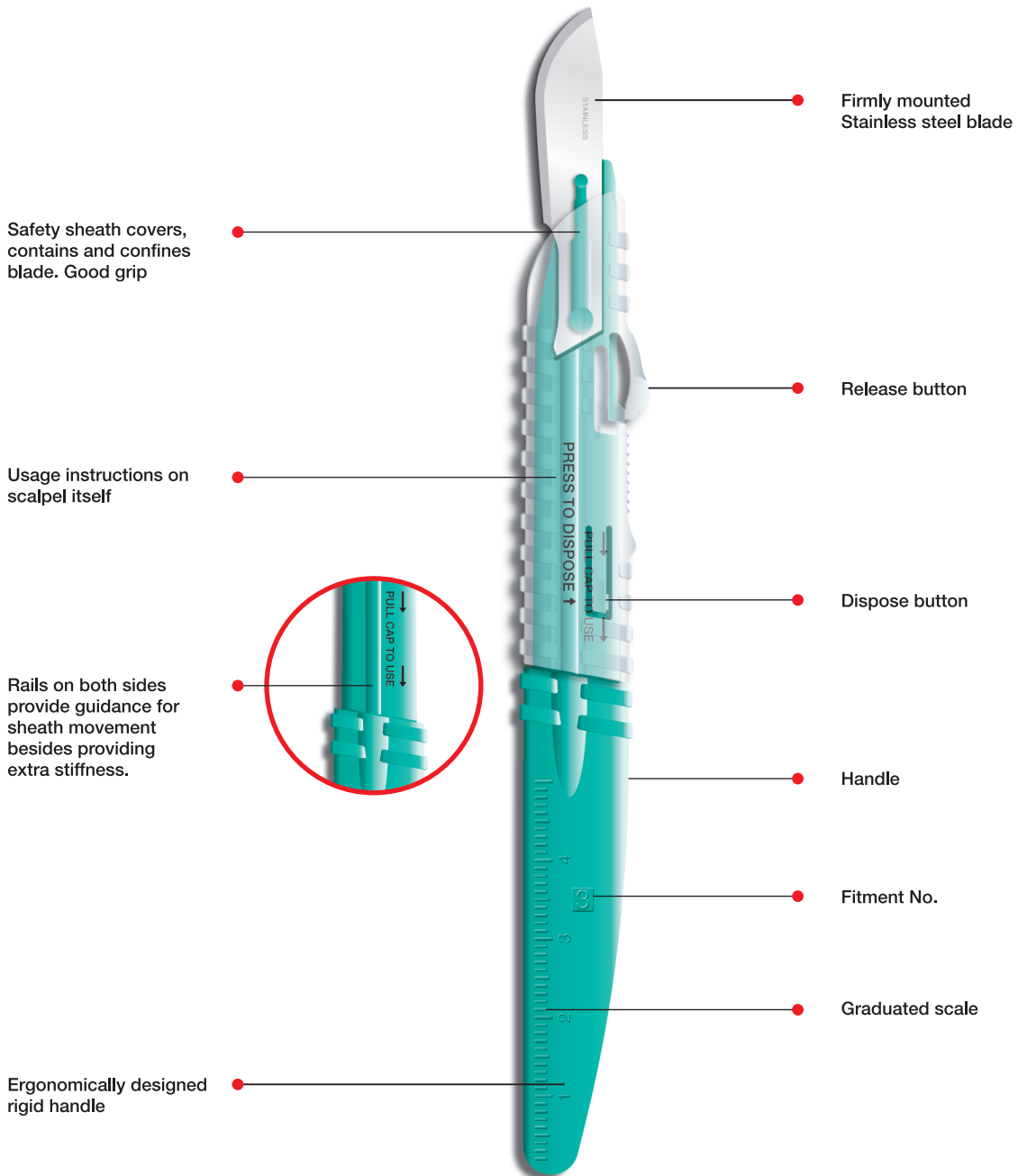

FITMENT 3		FITMENT 4	
Size	Reorder no	Size	Reorder no
10	11560	20	11570
11	11561	21	11571
11P	11531	22	11572
12	11562	23	11573
15	11565	24	11574
15C	11566	25	11578

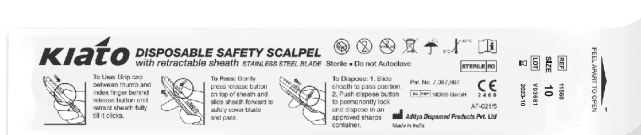

Packed in easy peel rigid blister pouches. 10 scalpels per unit box.

Boxes are colour coded for easy identification. 10 boxes per case.